

1938 -39 Pickup & Truck Grille, Hood, Fenders & Running Boards



1938-39 1/2 Ton Pickup & Panel Front Fender, Fiberglass

Grille

81C-8200	Grille, 1938	n.a
91C-8200	Grille, 1939	n.a
81C-8213	Grille center V8 emblem, 1938, chrome	100.00 ea
81C-8157	Grille center trim, 1938	n.a
91C-8157	Grille center trim, 1939	n.a
81C-8184	Grille outer trime ring, 1938-39	n.a

Radiator Shroud

81C-8084/5-B	Radiator side panels	n.a
81C-8240-B	Grille inner baffel	n.a
81C-16550	Grille to crossmember shield	n.a

Hood Handles & Ornaments

81C-8215-A	Hood handle	n.a
81C-8218-A	Hood handle base	n.a
81C-8227-A	Hood handle base gasket	n.a

1938-39 Pickup Hood Emblem

"Ford 85"



81C-16606	n.a
-----------	-----

Hood Latch

81A-16628	Hood latch cam	n.a
81A-16650	Hood handle tension spring	n.a

Hood

81C-16710-A	Hood top	n.a
81C-16618-A	Hood side panel RH	n.a
81C-16619-A	Hood side panel LH	n.a
81A-16750-RK	Hood side panel mounting studs & brackets	45.00 ea

Hood Hinge

Hood Hinge Brackets

99A-16796-S	Plain	25.00	pr
99A-16796-SS	Stainless	45.00	pr

Hood Hinge Bolts, w/safety wire

91A-16796-HK	Set of 4	7.50	ea
--------------	----------	------	----

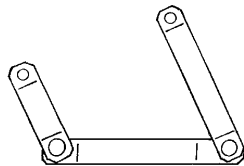

Hood Lacing & Bumpers

81C-16739-S	Hood lacing on grille, Rubber	10.00	ea
78-16740-S	Hood lacing on cowl	10.00	ea
81A-16761	Hood rubber bumper set	22.50	set

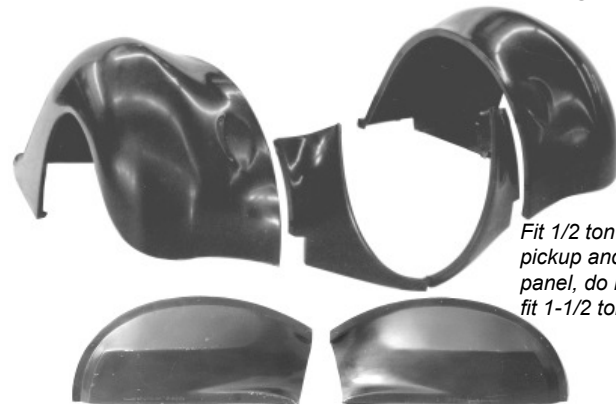

Fit 1/2 ton pickup and panel, do not fit 1-1/2 ton.

RFF3839PU	RH front, 1938-39 Pickup	470.00	ea
LFF3839PU	LH front, 1938-39 Pickup	470.00	ea
RFE3839PU	RH fender/grille extension	155.00	ea
LFE3839PU	LH fender/grille extension	155.00	ea
RFI3839PU	RH Inner front fender	175.00	ea
LF3839PU	LH Inner front fender	175.00	ea

1938-39 1/2 Ton Pickup & Panel Front Fender Brackets

81C-16025-R	RH Front fender/headlight support	n.a	
81C-16025-L	LH Front fender/headlight support	n.a	
81C-16067-R	RH Front bracket to frame brace	n.a	
81C-16067-L	LH Front bracket to frame brace	n.a	
81C-16094	Front fender skirt brace	27.50	ea

Rear Fenders, Fiberglass



Fits 1/2 ton pickup. To fit the panel truck, trim the inside flange.

RRF3841PU	RH: Plain (no tire dimple)	460.00	ea
LRF3841PU	LH: Plain (no tire dimple)	460.00	ea
RRF3841PUW	RH: w/dimple for spare tire	460.00	ea
LRF3841PUW	LH: w/dimple for spare tire	460.00	ea

1938 -39 Pickup & Truck Grille, Hood, Fenders & Running Boards

Teardrop Fender Skirts, Fiberglass

Excellent fiberglass reproductions of the aftermarket bubbled fender skirts that were so popular in the '50's. Includes locking arms to latch to the top of the fender, clamps to the bottom of the skirts to the front and rear of the wheel opening, stainless screws, and rubber seals.

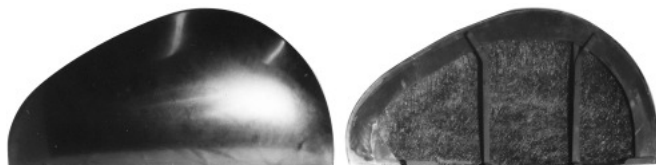

FST3536F Fender Skirts, fibreglass 685.00 pr

Rear Fender

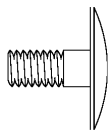
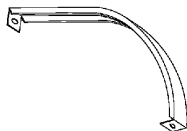

Brackets & Studs

81C-16391 Rear fender bracket, RH or LH 17.50 ea
 AH-1173 Bed wheelwell studs, set of 4 each 2.50 set

Fender Washer Sets

Rubber washers and large metal washers.

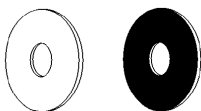

01A-16005-MW Set of 30 each 15.00 set

5/16-24 Cage Nuts

Welded to body and frame for fender and running board mounting.

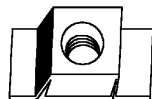

AH-3145 Cage nut 1.00 ea

Fender Welt

Black vinyl, 25 ft. length

48-16070-B 3/16" bead 10.00 ea
 48-16070-D 1/4" bead 10.00 ea

Vinyl, clad w/stainless bead, 8 ft.

48-16070-SS 7/32" bead 20.00 ea

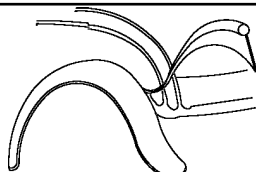

Vinyl, COLORED, Use part suffix to indicate color

Maroon: -MR, Caramel: -CR, Medium Blue: -BLM, Red: -RD, Dark Brown: -BRD, Dark Green: -GRD, White: -WH, Grey: -GY, Bright Orange: -OR, Yellow: -YL, Bright Red: -RR

48-16070-xx 25 ft length, Specify Color 35.00 ea

1938-39 Commercial Running Boards, Fiberglass

Strong fiberglass boards, over 1/4" thick. Steel braces included. Pickup running boards have stock type ribs molded in.



LRB3839PU RH Running board 345.00 ea
 LRB3839PU LH Running board 345.00 ea

Running Board to Bed Aprons, stamped steel

Mount between box and running boards in front of rear fenders.

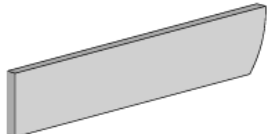

81C-16535-S 37.50 pr

1938 - 47 Cab Over Truck Grille, Fenders & Running Boards



1938-47 COE (Cab Over Engine) Truck Front Fenders & Running Boards, Fiberglass

RFF3847COE	RH Front fender	470.00 ea
LFF3847COE	LH Front fender	470.00 ea
LRB3847COE	RH Running board	175.00 ea
LRB3847COE	LH Running board	175.00 ea
RSA3847COE	RH Running board apron	116.00 ea
LSA3847COE	LH Running board apron	116.00 ea
FSA4147COE	Under grille apron, 1941-47	165.00 ea